

Round Pin, Anchor Shackle
019-A375R

- Drop forged anchor shackles meet the performance requirement of Federal Specification RR-C-271D type IVA.
- Shackles have a hot galvanized finish.

Ordering Information

Product Code	Description	RWL	Wt.
Round Pin Shackles			
019-A187R	$\frac{3}{16}$ " (4.76 mm) Round Pin Forged Anchor Shackle	666 lbs. 302 kg	0.07 lb. 0.03 kg
019-A250R	$\frac{1}{4}$ " (6.35 mm) Round Pin Forged Anchor Shackle	1000 lbs. 454 kg	0.14 lb. 0.06 kg
019-A312R	$\frac{5}{16}$ " (7.9 mm) Round Pin Forged Anchor Shackle	1500 lbs. 680 kg	0.22 lb. 0.09 kg
019-A375R	$\frac{3}{8}$ " (9.5 mm) Round Pin Forged Anchor Shackle	2000 lbs. 907 kg	0.33 lb. 0.15 kg
Screw Pin Shackles			
019-A187S	$\frac{3}{16}$ " (4.76 mm) Screw Pin Forged Anchor Shackle	666 lbs. 302 kg	0.07 lb. 0.03 kg
019-A250S	$\frac{1}{4}$ " (6.35 mm) Screw Pin Forged Anchor Shackle	1000 lbs. 454 kg	0.14 lb. 0.06 kg
019-A312S	$\frac{5}{16}$ " (7.9 mm) Screw Pin Forged Anchor Shackle	1500 lbs. 680 kg	0.22 lb. 0.09 kg
019-A375S	$\frac{3}{8}$ " (9.5 mm) Screw Pin Forged Anchor Shackle	2000 lbs. 907 kg	0.33 lb. 0.15 kg

RWL is based on the manufacturer's 6:1 safety factor.

Dimensions

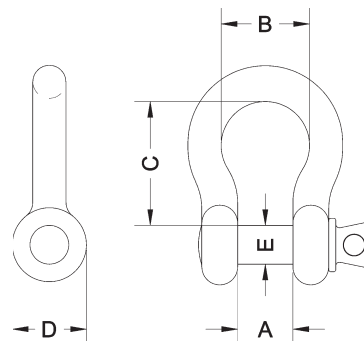

Product Code	A	B	C	D	E
019-A187	$\frac{3}{16}$ " 4.76 mm	$\frac{9}{16}$ " 14.3 mm	$\frac{7}{8}$ " 22.2 mm	$\frac{5}{8}$ " 15.8 mm	$\frac{1}{4}$ " 6.35 mm
019-A250	$\frac{15}{32}$ " 11.9 mm	$\frac{3}{4}$ " 19 mm	$1\frac{1}{8}$ " 28.5 mm	$\frac{3}{4}$ " 19 mm	$\frac{5}{16}$ " 7.9 mm
019-A312	$\frac{17}{32}$ " 13.5 mm	$\frac{15}{16}$ " 23.8 mm	$1\frac{1}{4}$ " 31.75 mm	$\frac{7}{8}$ " 22.2 mm	$\frac{3}{8}$ " 9.5 mm
019-A375	$\frac{21}{32}$ " 16.67 mm	$1\frac{1}{8}$ " 28.5 mm	$1\frac{7}{16}$ " 36.5 mm	1" 25.4 mm	$\frac{7}{16}$ " 11.1 mm