



**Turnbuckle
032-221J&E**

- Used for batten trimming or tensioning lines.
- Drop forged turnbuckles meeting the requirements of ASTM F1145-92, Type 1, Grade 1, made in the U.S.
- Hot galvanized finish.
- Other types and sizes are available on special order.

Ordering Information

Product Code	Description	RWL	Wt.
032-220J&E	5/16" x 4 1/2" (7.9 mm x 114 mm) Jaw & Eye Turnbuckle	800 lbs. 362 kg	0.5 lb. 0.2 kg
032-221J&E	3/8" x 6" (9.5 mm x 152 mm) Jaw & Eye Turnbuckle	1200 lbs. 544 kg	1 lb. 0.45 kg
032-221J&J	3/8" x 6" (9.5 mm x 152 mm) Jaw & Jaw Turnbuckle	1200 lbs. 544 kg	1 lb. 0.45 kg
032-222J&E	1/2" x 6" (12.7 mm x 152 mm) Jaw & Eye Turnbuckle	2200 lbs. 1000 kg	2 lbs. 0.9 kg
032-223J&E	1/2" x 12" (12.7 mm x 305 mm) Jaw & Eye Turnbuckle	2200 lbs. 1000 kg	2.5 lbs. 1.13 kg
032-224J&E	5/8" x 6" (15.875 mm x 152 mm) Jaw & Eye Turnbuckle	3500 lbs. 1587 kg	2.6 lbs. 1.18 kg

RWL is based on the manufacturer's 5:1 safety factor.

Dimensions

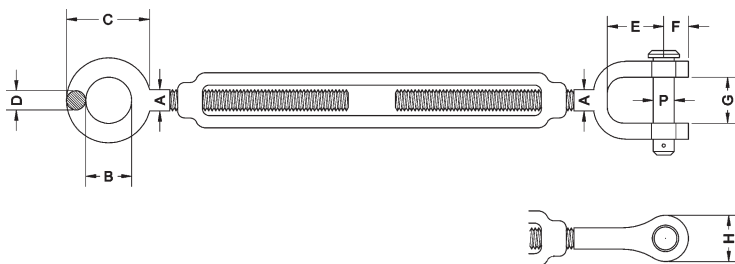

Product Code	A	B	C	D	E	F	G	H	P	Closed Length
032-220J&E	5/16" 7.9 mm	5/8" 15.875 mm	1 1/4" 31.75 mm	9/32" 7.1 mm	7/8" 22.22 mm	5/16" 7.9 mm	15/32" 11.9 mm	5/8" 15.87 mm	1/4" 6.35 mm	9 1/8" 232 mm
032-221J&E	3/8" 9.5 mm	3/4" 19 mm	1 1/2" 38 mm	11/32" 8.7 mm	1" 25.4 mm	13/32" 10.31 mm	1/2" 12.7 mm	13/16" 20.6 mm	5/16" 7.9 mm	11 1/2" 292 mm
032-221J&J	3/8" 9.5 mm	-	-	-	1" 25.4 mm	13/32" 10.31 mm	1/2" 12.7 mm	13/16" 20.6 mm	5/16" 7.9 mm	11 1/2" 292 mm
032-222J&E	1/2" 12.7 mm	1" 25.4 mm	2" 50.8 mm	7/16" 11.1 mm	1 9/32" 32.5 mm	1/2" 12.7 mm	5/8" 15.87 mm	1" 25.4 mm	7/16" 11.1 mm	13 1/4" 337 mm
032-223J&E	1/2" 12.7 mm	1" 25.4 mm	2" 50.8 mm	7/16" 11.1 mm	1 9/32" 32.5 mm	1/2" 12.7 mm	5/8" 15.87 mm	1" 25.4 mm	7/16" 11.1 mm	19 1/4" 489 mm
032-224J&E	5/8" 15.875 mm	1 1/4" 31.75 mm	2 5/16" 58.73 mm	17/32" 13.5 mm	1 21/32" 42 mm	21/32" 16.67 mm	7/8" 22.32 mm	1 5/16" 33 mm	1/2" 12.7 mm	14 5/8" 371 mm