



**Turnbuckle
032-221J&E**

- Used for batten trimming or tensioning lines.
- Drop forged turnbuckles meeting the requirements of ASTM F1145-92, Type 1, Grade 1, made in the U.S.
- Hot galvanized finish.
- Other types and sizes are available on special order.

Ordering Information

Product Code	Description	RWL	Wt.
032-220J&E	5/16" x 4 1/2" Jaw & Eye Turnbuckle	800 lbs.	0.5 lb.
032-221J&E	3/8" x 6" Jaw & Eye Turnbuckle	1,200 lbs.	1 lb.
032-221J&J	3/8" x 6" Jaw & Jaw Turnbuckle	1,200 lbs.	1 lb.
032-222J&E	1/2" x 6" Jaw & Eye Turnbuckle	2,200 lbs.	2 lbs.
032-223J&E	1/2" x 12" Jaw & Eye Turnbuckle	2,200 lbs.	2.5 lbs.
032-224J&E	5/8" x 6" Jaw & Eye Turnbuckle	3,500 lbs.	2.6 lbs.

RWL is based on the manufacturer's 5:1 safety factor.

Dimensions

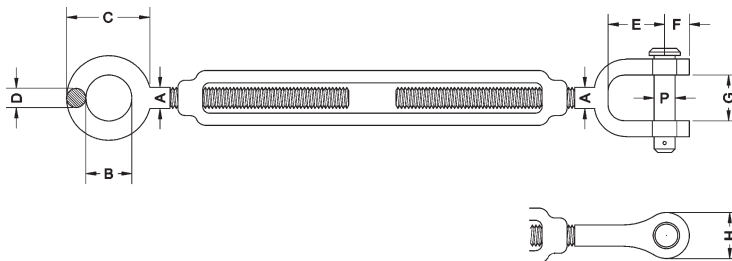

Product Code	A	B	C	D	E	F	G	H	P	Closed Length
032-220J&E	5/16"	5/8"	1 1/4"	9/32"	7/8"	5/16"	15/32"	5/8"	1/4"	9 1/8"
032-221J&E	3/8"	3/4"	1 1/2"	11/32"	1"	13/32"	1/2"	13/16"	5/16"	11 1/2"
032-221J&J	3/8"	-	-	-	1"	13/32"	1/2"	13/16"	5/16"	11 1/2"
032-222J&E	1/2"	1"	2"	7/16"	1 9/32"	1/2"	5/8"	1"	7/16"	13 1/4"
032-223J&E	1/2"	1"	2"	7/16"	1 9/32"	1/2"	5/8"	1"	7/16"	19 1/4"
032-224J&E	5/8"	1 1/4"	2 5/16"	17/32"	1 21/32"	21/32"	7/8"	1 5/16"	1/2"	14 5/8"